

CSR:

Amount:

5 NOV 2024 PM 10:43
YUMA CITY CLERK



SPECIAL EVENT LICENSE

APPLICATION FEE \$25.00 PER DAY

Arizona Department of Liquor Licenses and Control
800 W. Washington St. 5th Floor Phoenix, AZ 85007
(602) 542-5141

DLLC USE ONLY

Job #:
Date Accepted:
CSR:
License #:

Application MUST be submitted to the Department of Liquor 10 days prior to the event.

SECTION 1 Applicant must be a member of a qualifying nonprofit organization, political party, or Government entity and authorized by an Officer, Director, or Chairperson of the Organization.

1. Applicant: DOUGLAS CATHY
(Must be an Officer/Member of the Non Profit Entity) Last First Middle
2. Applicant's mailing address: 180 W. 1ST STREET, SUITE E YUMA AZ 85364
Street City State Zip
3. Applicants home/cell phone: 928-304-8941 Applicant's business phone: 928-373-5192
4. Applicant's email address: CATHY.DOUGLAS@YUMAAZ.GOV
5. Special Event Name: CHRISTMAS AT THE CROSSING
6. Name of Non-Profit Organization, Candidate or Political Party/Gov.: YUMA CROSSING NATIONAL HERITAGE AREA
7. Non-Profit/IRS Tax Exempt Number: 80-0038830
8. Arizona Corporation Commission File #: 10172498 If out of State please specify: _____
(Attach letter of good standing)
9. Event Location Name: COLORADO RIVER STATE HISTORIC PARK
10. Event Address: 201 N. 4TH AVENUE YUMA, AZ 85364

Dates and Hours of Event - Days must be consecutive and may not exceed 10 consecutive days.

****SEPARATE APPLICATION FOR EACH "NON-CONSECUTIVE" DAY****

Days	Date	Day of Week	Event Start Time AM/PM	License End Time AM/PM
DAY 1:	<u>12/19/2024</u>	<u>THURSDAY</u>	<u>5PM</u>	<u>11PM</u>
DAY 2:	<u>12/20/2024</u>	<u>FRIDAY</u>	<u>5PM</u>	<u>11PM</u>
DAY 3:	<u>12/21/2024</u>	<u>SATURDAY</u>	<u>5PM</u>	<u>11PM</u>
DAY 4:	_____	_____	_____	_____
DAY 5:	_____	_____	_____	_____
DAY 6:	_____	_____	_____	_____
DAY 7:	_____	_____	_____	_____
DAY 8:	_____	_____	_____	_____
DAY 9:	_____	_____	_____	_____
DAY10:	_____	_____	_____	_____

Name: YUMA CROSSING NATIONAL HERITAGE AREA Percentage: 100%
 Address: 180 W. 1ST STREET, SUITE E YUMA AZ 85364
Street City State Zip
 Name: _____ Percentage: _____
 Address: _____
Street City State Zip

Please read A.R.S. § 4-203.02 Special event license; rules and R19-1-205 Requirements for a Special Event License.

ALL ALCOHOLIC BEVERAGE SALES MUST BE FOR CONSUMPTION AT THE EVENT SITE ONLY.

NO ALCOHOLIC BEVERAGES SHALL LEAVE A SPECIAL EVENT UNLESS THEY ARE IN AUCTION WINE OR DISTILLED SPIRITS PULL SEALED CONTAINERS OR THE SPECIAL EVENT LICENSE IS STACKED WITH WINE /CRAFT DISTILLERY FESTIVAL LICENSE.

SECTION 5 License premises diagram. The licensed premises for your special event is the area in which you are authorized to sell, dispense or serve alcoholic beverages under the provisions of your license. Please attach a diagram of your special event licensed premises. Please show dimensions, serving areas, fencing, barricades, or other control measures and security position.



If the special event will be held at a location without a permanent liquor license or if the event will be on any portion of a location that is not covered by the existing liquor license, this application must be approved by the local governing body before submitting to the Department of Liquor Licenses and Control. Please contact the local governing board for additional information.

APPLICANT SIGNATURE

Declaration:
 I, (Print Name) CATHY DOUGLAS, declare under penalty of perjury that I am authorized to submit this application. I have read the contents of this application, and to the best of my knowledge believe all statements made on this application to be true, correct and complete.

 Signature

LOCAL GOVERNING BODY

Date Received: 11/05/2024
 I, John D. Simonton Acting City Administrator recommend APPROVAL DISAPPROVAL
(Government Official) (Title)
 On behalf of City of Yuma  11/05/2024 928-373-5305
(City, Town, County) Signature Date Phone

The local governing body (city, town or municipality where the fair/festival will take place) may require additional applications to be completed and submitted. Please check with local government as to how far in advance they require these applications to be submitted. Additional licensing fees may also be required before approval may be granted.

AZDLLC USE ONLY

APPROVAL DISAPPROVAL BY: _____ DATE: _____

SECTION 2 What type of security and control measures will you take to prevent violations of liquor laws at this event?
(List type and number of police/security personnel and type of fencing or control barriers, if applicable.)

Number of Police 4 Number of Security Personnel Fencing Barriers

Must explain security measures: UNIFORMED SECURITY STATIONED AT ENTRANCE AND EXITS TO INSURE NO OUSIDE ALCOHOL COMES IN AND NO ALCOHOL LEAVES THE EVENT. ID'S WILL BE CHECKED AND WRIST BAND WORN BY THOSE 21 YEARS AND OLDER.

SECTION 3 What is the purpose of this event?

On-site consumption Off-site (auction/wine/distilled spirits pull) Both

How is this special event going to conduct all dispensing, serving, and selling of spirituous liquors?
Check one of the following boxes. (R-19-318)

A) Special Event being held on an **unlicensed** premises will require approval and signature by the Local Governing Body on page 3. (If checked move to section 4)

B) Will this event be held on a currently licensed premises and within the already approved and licensed area?
(**Must attach a letter from the licensed premises with an explanation of the option checked below**)

Name of Business License Number Phone (Include Area Code)

Place license in non-use - *Special Event Licensee selling all alcohol without retailer involvement*
Must attach letter from the location suspending license for duration of special event

Dispense and serve all spirituous liquors under retailer's license – *Business operates normally, minimum of 25% of gross revenue from alcohol sales is donated to licensee*

Dispense and serve all spirituous liquors under special event - *The special event licensee is in charge of selling alcohol that was purchased or donated by the special event licensee. The retailers existing alcohol inventory must be separated from any alcohol used during the special event. **Must attach letter from the location suspending license for duration of special event***

Split premise between special event and retail location - *Both the special event licensee and the retailer will conduct sales of alcohol. (These sales will be done in separate areas. If alcohol is donated or purchased by the special event licensee it must be in a separate area than the alcohol that is dispensed by the licensed retailer.)*

Off Sale only - Wine/Distilled Spirits Pull, Live or Silent Auctions – *Retailer will still be permitted to conduct all normal sale and service of alcohol.*

SECTION 4

1. Has the applicant been convicted of a felony, or had a liquor license revoked within the last five (5) years?

Yes No If yes, attach letter of explanation.

2. How many special event days have been issued to this organization during the calendar year? 6

3. Is the Organization using the services of a Special Event Contractor? (A licensee can utilize the services of a special event contractor who may purchase and sell alcohol on behalf of the licensee. If no special event contractor is listed, the licensee is responsible for the sales and service of alcohol.)

Yes No If yes, please provide the Name of the Special Event Contractor: _____

4. Is the organization using the services of a series 6, 7, 11, or 12 licensee to manage the sale or service of alcohol? (Licensees who hold a series 6, 7, 11, or 12 license are automatically qualified to be the special event contractor)

Yes No if yes, please provide the Name of Licensee: _____ License #: _____

5. List the name of the Individual or Organization that will receive revenues, **MUST EQUAL 100 PERCENT.**

Attach additional sheet if necessary.

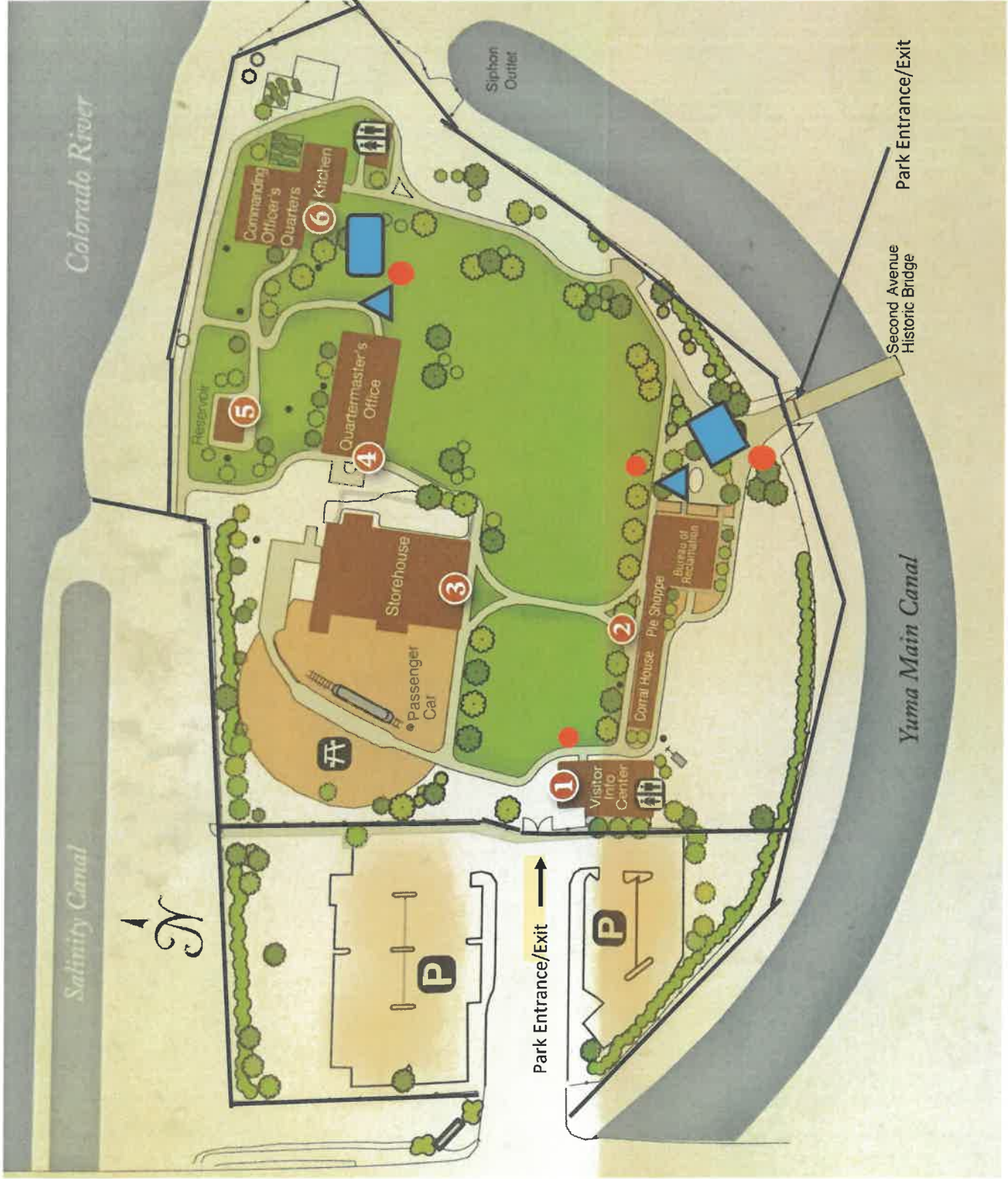

- SECURITY
- BAR
- FENCE
- ID Check & Wrist Bands

COLORADO RIVER STATE HISTORIC PARK 201 N. 4TH AVENUE YUMA, AZ